



**PREMIER
PROPERTIES**

COMMERCIAL
REAL ESTATE

FOR LEASE

270 UNIVERSITY AVE

Palo Alto, CA

±3,300 Sq. Ft.
RETAIL / PERSONAL SERVICES

BRAD EHIKIAN

Partner
dre license #01736391

☎ | 650.618.3001

✉ | brad.ehikian@prprop.com

JON GOLDMAN

Partner
dre license #01295503

☎ | 650.618.3003

✉ | jon.goldman@prprop.com

JESSE EBNER

Vice President
dre license #02055989

☎ | 650.618.3017

✉ | jesse.ebner@prprop.com

PROPERTY DESCRIPTION

- ▮ Floor-to-Ceiling Glass Street Frontage
- ▮ Beautiful Building on a Prime Downtown Block
- ▮ Excellent Signage Opportunities
- ▮ Surrounded by Free Street Parking and Parking Garages
- ▮ Walking Distance to Caltrain Station
- ▮ Neighbors Countless Downtown Restaurants, Retailers, & Amenities
- ▮ Available December 1, 2021



BRAD EHIKIAN
Partner
dre license #01736391
☎ | 650.618.3001
✉ | brad.ehikian@prprop.com

JON GOLDMAN
Partner
dre license #01295503
☎ | 650.618.3003
✉ | jon.goldman@prprop.com

JESSE EBNER
Vice President
dre license #02055989
☎ | 650.618.3017
✉ | jesse.ebner@prprop.com

FLOOR PLAN

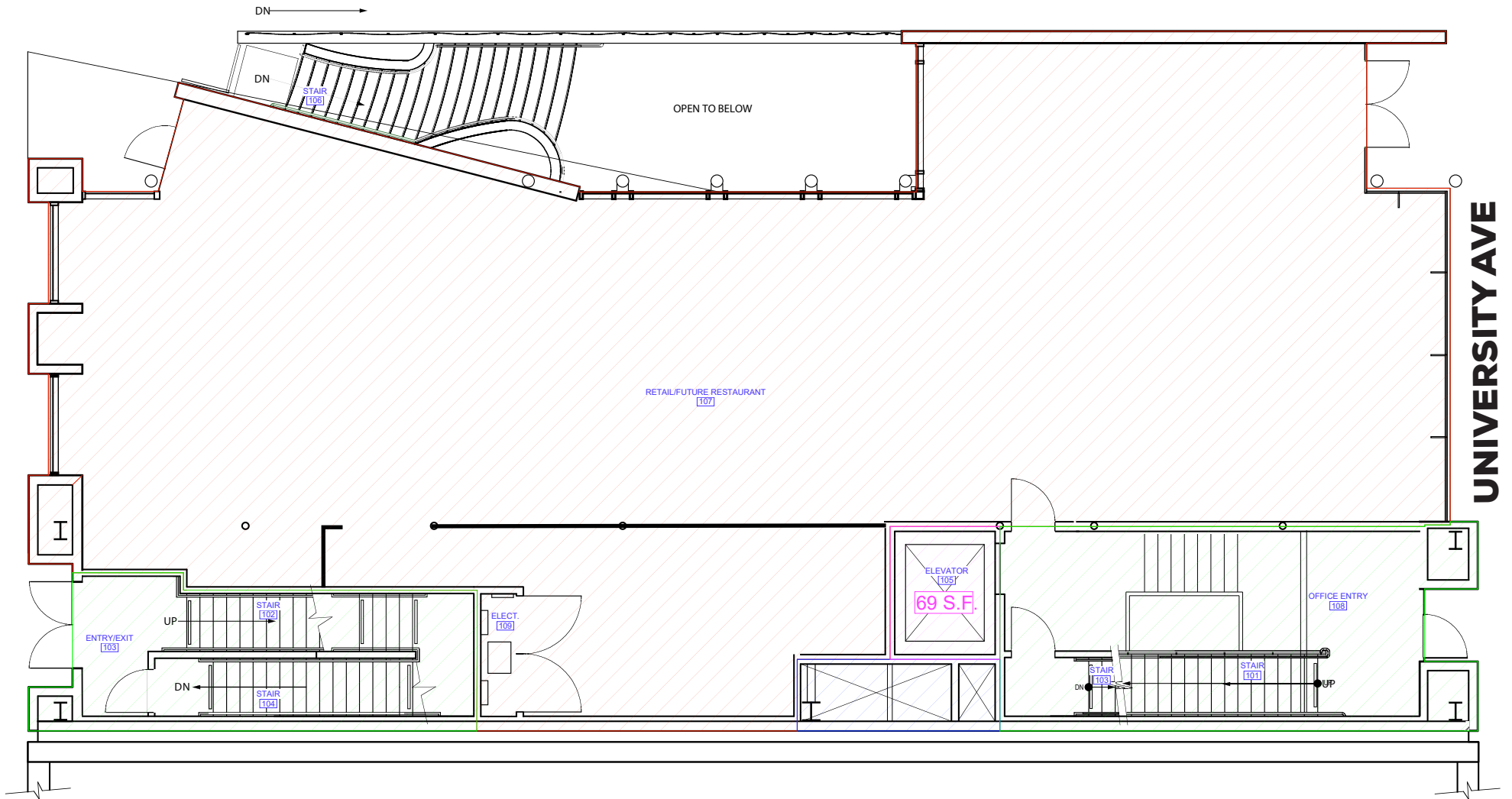

BRAD EHIKIAN
Partner
dre license #01736391
☎ | 650.618.3001
✉ | brad.ehikian@prprop.com

JON GOLDMAN
Partner
dre license #01295503
☎ | 650.618.3003
✉ | jon.goldman@prprop.com

JESSE EBNER
Vice President
dre license #02055989
☎ | 650.618.3017
✉ | jesse.ebner@prprop.com

INTERIOR PHOTOS



BRAD EHIKIAN
Partner
dre license #01736391
☎ | 650.618.3001
✉ | brad.ehikian@prprop.com

JON GOLDMAN
Partner
dre license #01295503
☎ | 650.618.3003
✉ | jon.goldman@prprop.com

JESSE EBNER
Vice President
dre license #02055989
☎ | 650.618.3017
✉ | jesse.ebner@prprop.com

AMENITY MAP

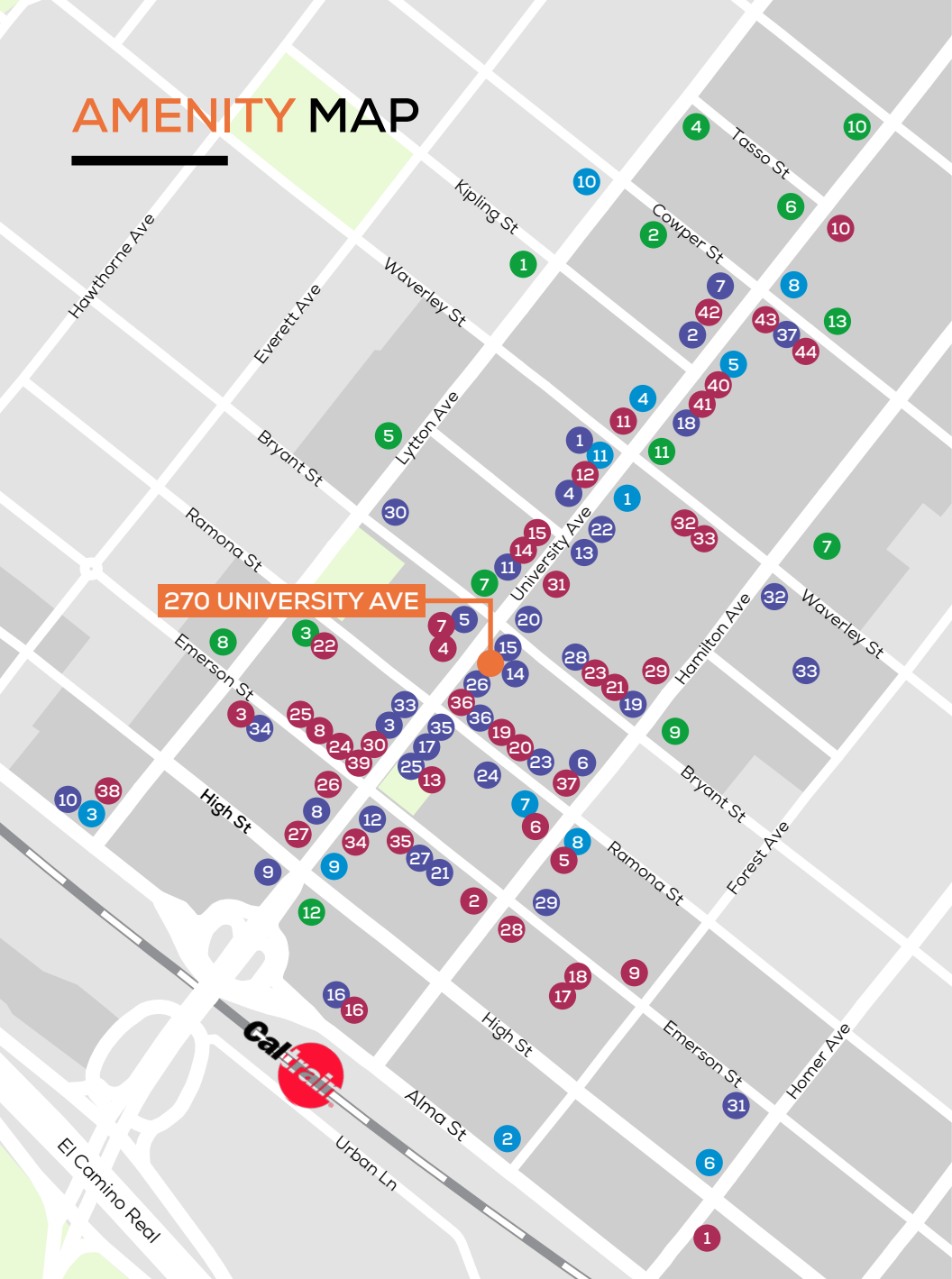

270 UNIVERSITY AVE

SHOPPING / SERVICES

- 1 B8ta Palo Alto
- 2 Footwear Etc
- 3 Verizon
- 4 Design Within Reach
- 5 Restoration Hardware
- 6 Shinola
- 7 Sprint Store
- 8 Palo Alto Bicycles
- 9 Natural Mattress Store
- 10 E-bike Annex
- 11 Rejuvenation
- 12 West Elm
- 13 Apple Store
- 14 Jos. A. Banks
- 15 Keen Garage
- 16 Patagonia
- 17 Vans
- 18 lululemon
- 19 UPS Store
- 20 Walgreens
- 21 Bells Books
- 22 CVS
- 23 Warby Parker
- 24 Good Vibrations
- 25 Nest Bedding
- 26 The Shade Store
- 27 Mac's Smoke Shop
- 28 Timothy Adams
- 29 Rumble Fitness
- 30 Form Fitness
- 31 Whole Foods
- 32 US Postal Service
- 33 Stanford Theatre
- 34 Aquarius Theatre
- 35 Juut Salon
- 36 Edge Hair Salon
- 37 Garden Court

RESTAURANTS

- 1 Saint Michael Alley
- 2 Palo Alto Creamery
- 3 Evvia
- 4 Orens Hummus
- 5 Reposado
- 6 Osteria
- 7 Local Union
- 8 Rangoon Ruby
- 9 Pizza Delfina
- 10 Tamarine
- 11 Yayoi Palo Alto
- 12 Crepevine
- 13 Pizza My Heart
- 14 La Strada
- 15 Joya
- 16 Pampas
- 17 Tacolicious
- 18 Dan Gordon's
- 19 Nola
- 20 The Old Pro
- 21 Zola
- 22 Bird Dog
- 23 Ramen Nagi
- 24 Steam
- 25 Patxis
- 26 Wahlburgers
- 27 Lemonade
- 28 Nobu
- 29 Curry Up Now
- 30 Subway
- 31 SliderBar
- 32 Ethlys Fancy
- 33 Tai Pan
- 34 Sprout Café
- 35 Bare Bowls
- 36 Salt and Straw
- 37 sweetgreen
- 38 Darbar Indian Cuisine
- 39 Scoop
- 40 Sushirrito
- 41 Cream
- 42 Cielo
- 43 Gyros Gyros
- 44 Il Fornaio

BANKS

- 1 Avid Bank
- 2 Boston Private
- 3 Comerica Bank
- 4 bank of america
- 5 Presidio Bank
- 6 Stanford Credit Union
- 7 Wells Fargo
- 8 City National Bank
- 9 Chase Bank
- 10 HSBC Bank
- 11 Union Bank
- 12 E*TRADE Bank
- 13 Bank of The West

COFFEE

- 1 Starbucks
- 2 Philz Coffee
- 3 Coupa Cafe
- 4 Café Venetia
- 5 Blue Bottle Café
- 6 Peets
- 7 Bistro Maxine
- 8 Joe & the Juice
- 9 Verve
- 10 Mademoiselle Colette
- 11 Paris Baguette



**PREMIER
PROPERTIES**
COMMERCIAL
REAL ESTATE

BRAD EHIKIAN

Partner
dre license #01736391
☎ | 650.618.3001
✉ | brad.ehikian@prprop.com

JON GOLDMAN

Partner
dre license #01295503
☎ | 650.618.3003
✉ | jon.goldman@prprop.com

JESSE EBNER

Vice President
dre license #02055989
☎ | 650.618.3017
✉ | jesse.ebner@prprop.com

TRANSPORTATION AERIAL



BRAD EHIKIAN
 Partner
 dre license #01736391
 ☎ | 650.618.3001
 ✉ | brad.ehikian@prprop.com

JON GOLDMAN
 Partner
 dre license #01295503
 ☎ | 650.618.3003
 ✉ | jon.goldman@prprop.com

JESSE EBNER
 Vice President
 dre license #02055989
 ☎ | 650.618.3017
 ✉ | jesse.ebner@prprop.com

DEMOGRAPHICS



ONE-MILE POPULATION: 10,168

MEDIAN AGE

50.1

MEDIAN NET WORTH



FAMILIES



PER CAPITA
INCOME

111,123



Average Household Income

\$294,344

Average Household Size: 2.62

Owner Occupied Housing Units: 3,205

Renter Occupied Housing Units: 670

Median Household Income: \$200,000

MAJOR EMPLOYERS:

Data for all businesses in area	1 mile
Total Businesses:	954
Total Employees:	6,237
Total Residential Population:	10,168
Employee/Residential Population Ratio (per 100 Residents)	61

Lucile Packard
Children's Hospital
Stanford
VA PAHCS
Veterans Affairs Palo Alto Health Care System

Stanford
HEALTH CARE
vmware
varian



Sutter Health
Palo Alto Medical
Foundation



BRAD EHIKIAN
Partner
dre license #01736391
☎ | 650.618.3001
✉ | brad.ehikian@prprop.com

JON GOLDMAN
Partner
dre license #01295503
☎ | 650.618.3003
✉ | jon.goldman@prprop.com

JESSE EBNER
Vice President
dre license #02055989
☎ | 650.618.3017
✉ | jesse.ebner@prprop.com

CITY PARKING LOT MAP



BRAD EHIKIAN
Partner
dre license #01736391
☎ | 650.618.3001
✉ | brad.ehikian@prprop.com

JON GOLDMAN
Partner
dre license #01295503
☎ | 650.618.3003
✉ | jon.goldman@prprop.com

JESSE EBNER
Vice President
dre license #02055989
☎ | 650.618.3017
✉ | jesse.ebner@prprop.com