

FOR SUBLEASE

2114 BROADWAY ST, REDWOOD CITY, CA

±3,058 SQ. FT. OFFICE



**PREMIER
PROPERTIES**
COMMERCIAL
REAL ESTATE

BRAD EHIKIAN
Partner
dre license #01736391
| 650.618.3001
| brad.ehikian@prprop.com

JON GOLDMAN
Partner
dre license #01295503
| 650.618.3003
| jon.goldman@prprop.com

JESSE EBNER
Vice President
dre license #02055989
| 650.618.3017
| jesse.ebner@prprop.com

PROPERTY HIGHLIGHTS

- ▶ Recently Renovated Class A Office Space
- ▶ ±3,058 Sq. Ft. Ground Floor Suite
- ▶ Excellent Location in the Heart of Downtown Redwood City
- ▶ Large, Glass-Walled Boardroom
- ▶ Mostly Open Layout
- ▶ Expansive Private Patio
- ▶ Office Entrance on Broadway
- ▶ High-Visibility Signage Opportunities
- ▶ Shares Building with Philz Coffee
- ▶ In-Suite Restrooms & Break Area
- ▶ Three (3) Blocks from CalTrain
- ▶ Easy Access to El Camino Real, Woodside Road, & U.S. 101
- ▶ LED: June 30, 2024



FLOOR PLAN

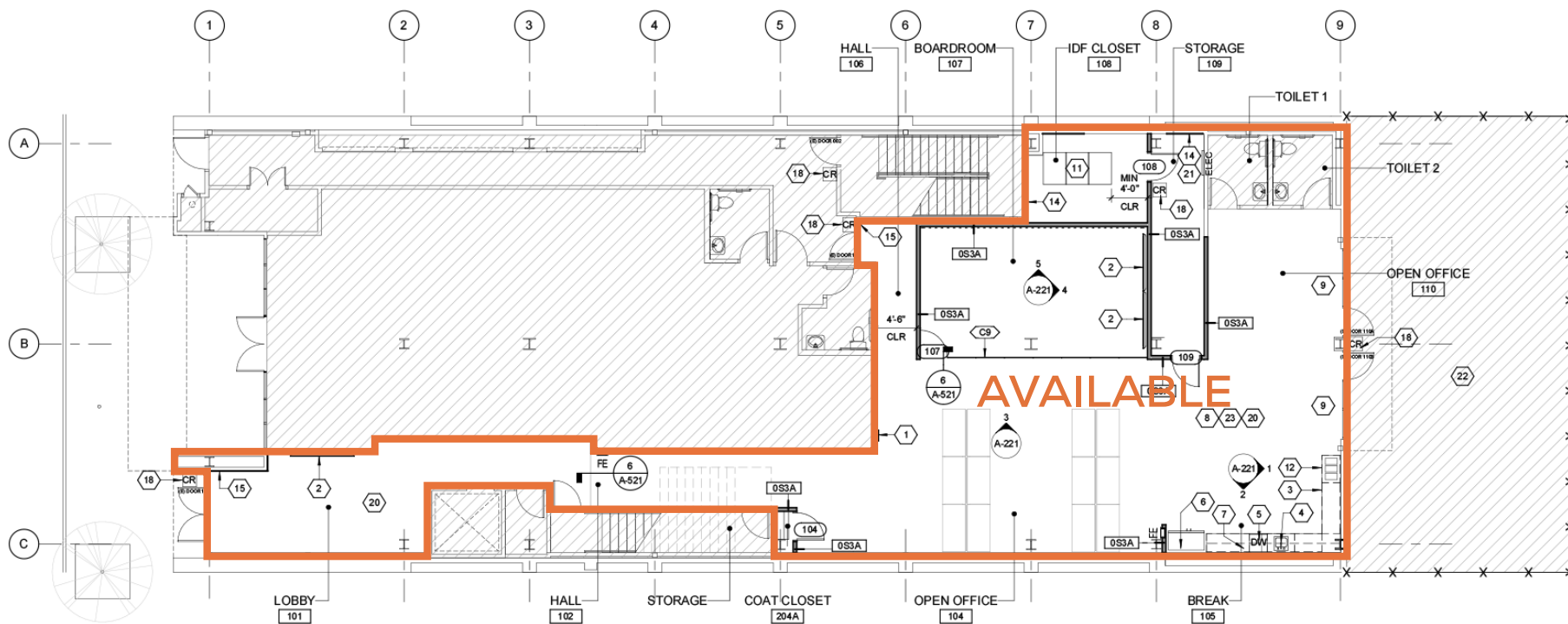

TRANSPORTATION MAP

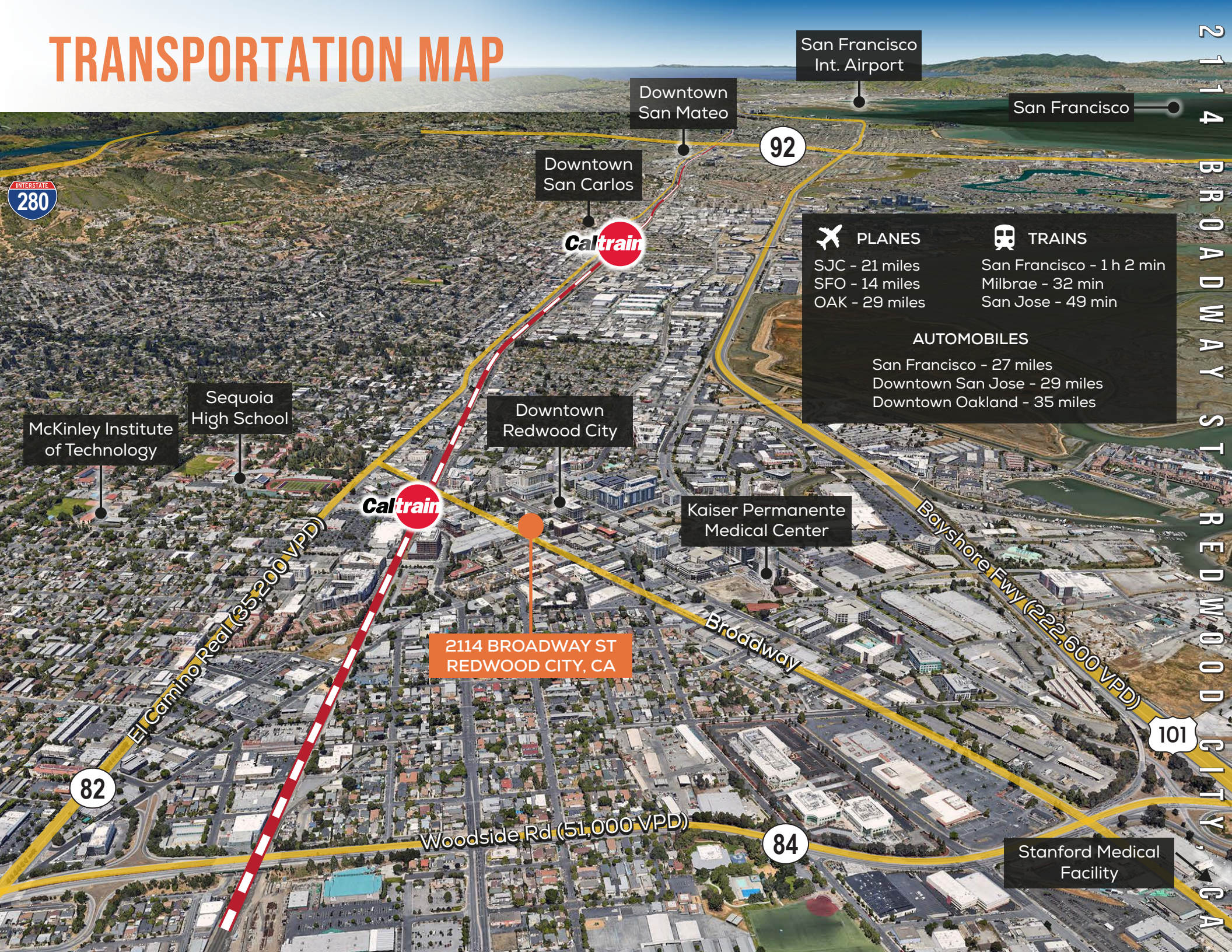

2114 BROADWAY ST, REDWOOD CITY, CA

San Francisco
Int. Airport

Downtown
San Mateo

San Francisco

92

Downtown
San Carlos

Caltrain

 **PLANES**
SJC - 21 miles
SFO - 14 miles
OAK - 29 miles

 **TRAINS**
San Francisco - 1 h 2 min
Milbrae - 32 min
San Jose - 49 min

AUTOMOBILES

San Francisco - 27 miles
Downtown San Jose - 29 miles
Downtown Oakland - 35 miles

INTERSTATE
280

McKinley Institute
of Technology

Sequoia
High School

Downtown
Redwood City

Kaiser Permanente
Medical Center

2114 BROADWAY ST
REDWOOD CITY, CA

Broadway

Bayshore Fwy (222,600 VPD)

El Camino Real (35,200 VPD)

82

Woodside Rd (51,000 VPD)

84

101

Stanford Medical
Facility

DEMOGRAPHICS



ONE-MILE POPULATION: 27,208

MEDIAN AGE

34.0

AVERAGE HOUSEHOLD SIZE



FAMILIES



FAMILIES

5,398



Average Household Income

\$89,424

Average Household Size: **2.88** | Owner Occupied Housing Units: **1,844** | Renter Occupied Housing Units: **7,210** | Median Household Income: **\$64,424** | Average Household Income: **\$89,424**

MAJOR EMPLOYERS:

Data for all businesses in area	1 mile
Total Businesses:	2,195
Total Employees:	26,890
Total Residential Population:	27,208
Employee/Residential Population Ratio (per 100 Residents)	99

FOR SUBLEASE

2114 BROADWAY ST, REDWOOD CITY, CA

±3,058 SQ. FT. OFFICE



**PREMIER
PROPERTIES**
COMMERCIAL
REAL ESTATE

BRAD EHIKIAN

Partner
dre license #01736391
| 650.618.3001
| brad.ehikian@prprop.com

JON GOLDMAN

Partner
dre license #01295503
| 650.618.3003
| jon.goldman@prprop.com

JESSE EBNER

Vice President
dre license #02055989
| 650.618.3017
| jesse.ebner@prprop.com